

How to fit a **LEFT** ear mould and a Behind the Ear Hearing Aid.

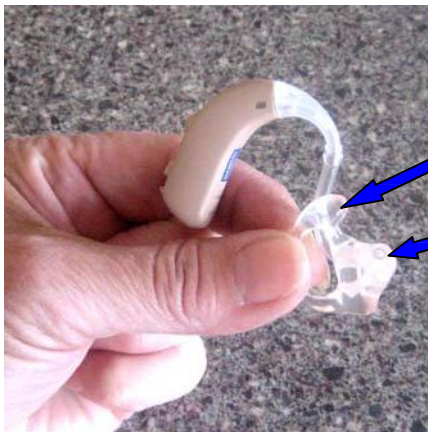

Hook

Canal insert

1. With your **LEFT** hand hold the edge of the ear mould between your index finger and thumb.



2. Feel for the jawbone joint next to your left ear with a finger on your **RIGHT** hand.



3. Lift the ear mould in your left hand to touch the finger on the jawbone joint.



4. Slide the ear mould backwards until the canal insert part of the ear mould is inside your ear.



5. Gently twist the ear mould slightly backwards to fit the hook part at the top of the ear mould behind and under the fold near the top of your ear.



6. You may need to use your **RIGHT** hand to pull your ear lobe down so that you can push the mould deeper into your ear.



7. Take your thumb away and use your finger to press the ear mould into your ear.



8. Check that the hook part of the ear mould is under the fold near the top of your ear.



9. Your ear mould should now be comfortably in place.



10. Next, lift the hearing aid over the top of your ear....



11. ...and sit it behind your ear.



12. You have now successfully fitted your ear mould and hearing aid.

Each night when you remove your hearing aid always wipe the mould with a damp cloth or wet wipe to keep it clean. Ear mould tubing should be replaced every 4-6 months by your Audiology Department.

For further advice contact the Audiology Department on 604 7113